

Rez-de-chaussée

Plan général "Buffet de la gare" - "I. GUSTAVE DORÉ INTIME ET SPECTACULAIRE"

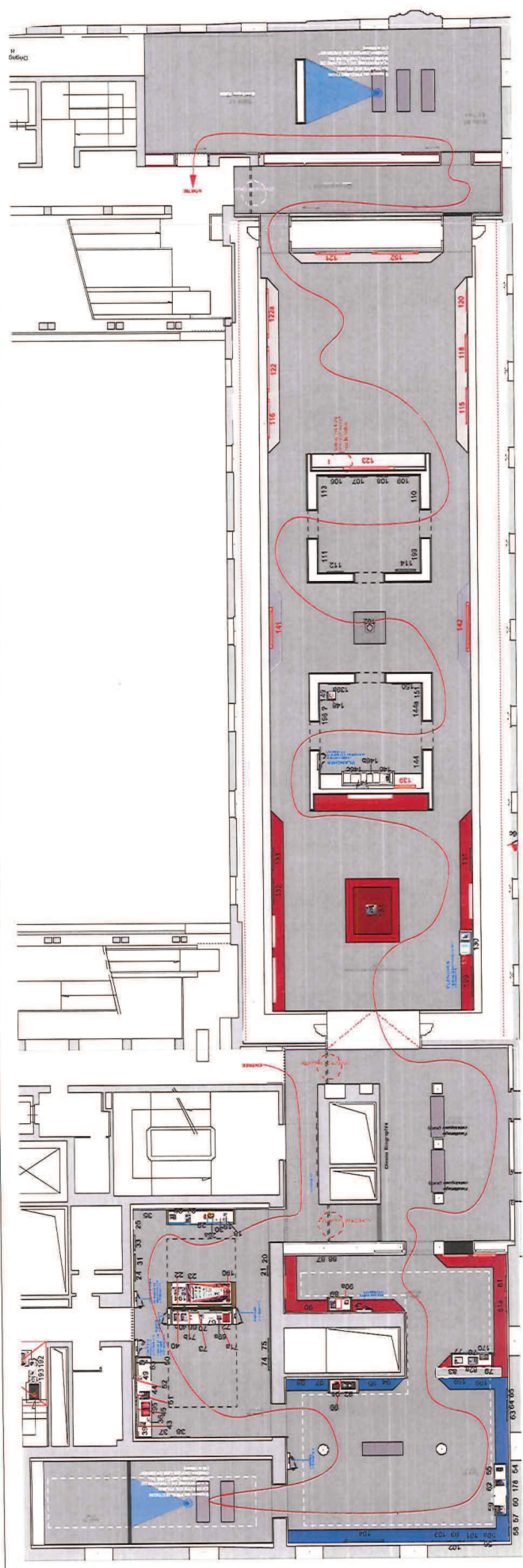

Plan général "Niveau R+5" - "II. DE LA CARICATURE AU PAYSAGE"

PROJET	LEU	PHASE	TRUC	ECHÉLLE	DATE	LOT
MATRIÈRE ÉCRIVAIN	MUSÉE D'ORSAY	DCE		1/200	16/01/2014	
Agence NC	Etablissement public du musée d'Orsay et du musée de l'Orangerie (EPMO)			Plans généraux		
50 rue du Fay, du Temple, 75011 Paris, France						
Tél. +33 (0)1 46 28 35 96						
Fax +33 (0)1 46 28 35 70						

"I. GUSTAVE DORÉ INTIME ET SPECTACULAIRE"

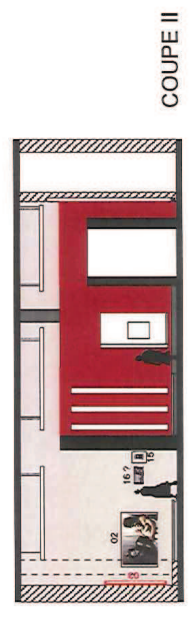
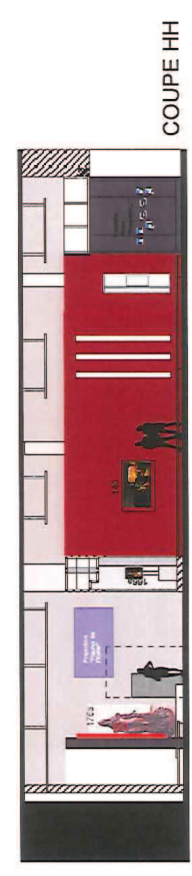
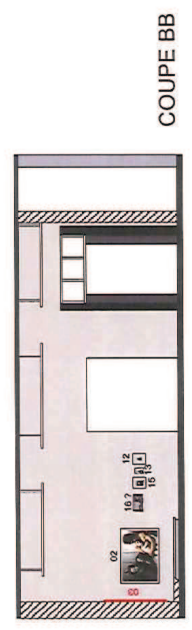
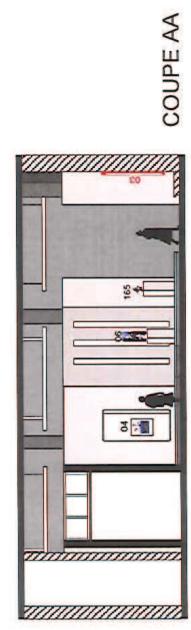
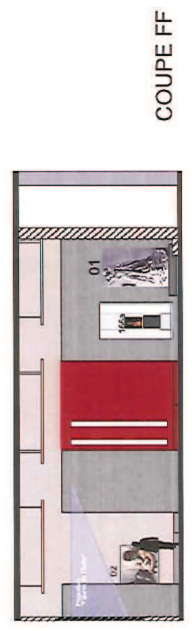
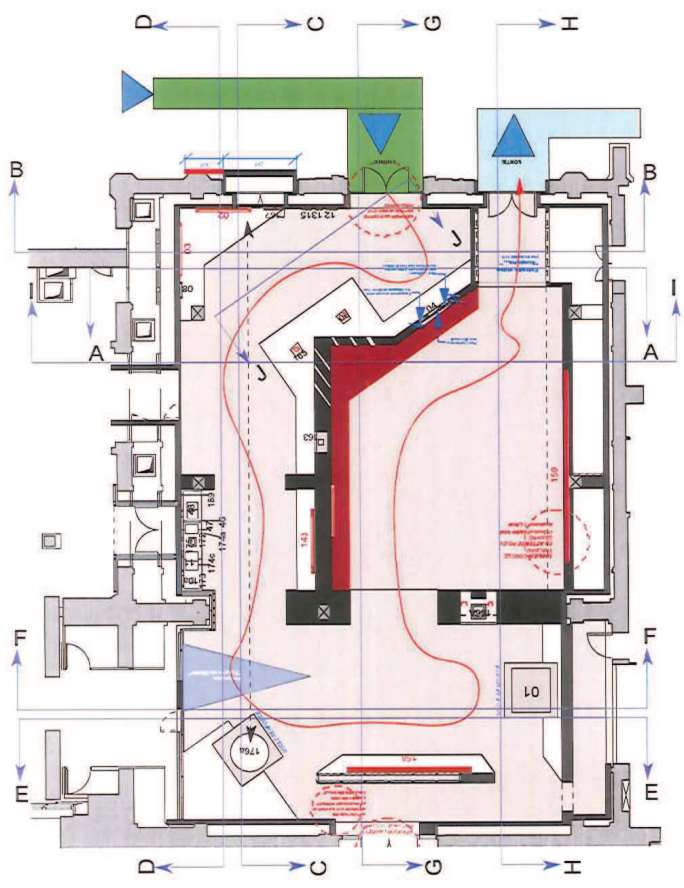

"I. GUSTAVE DORÉ INTIME ET SPECTACULAIRE"

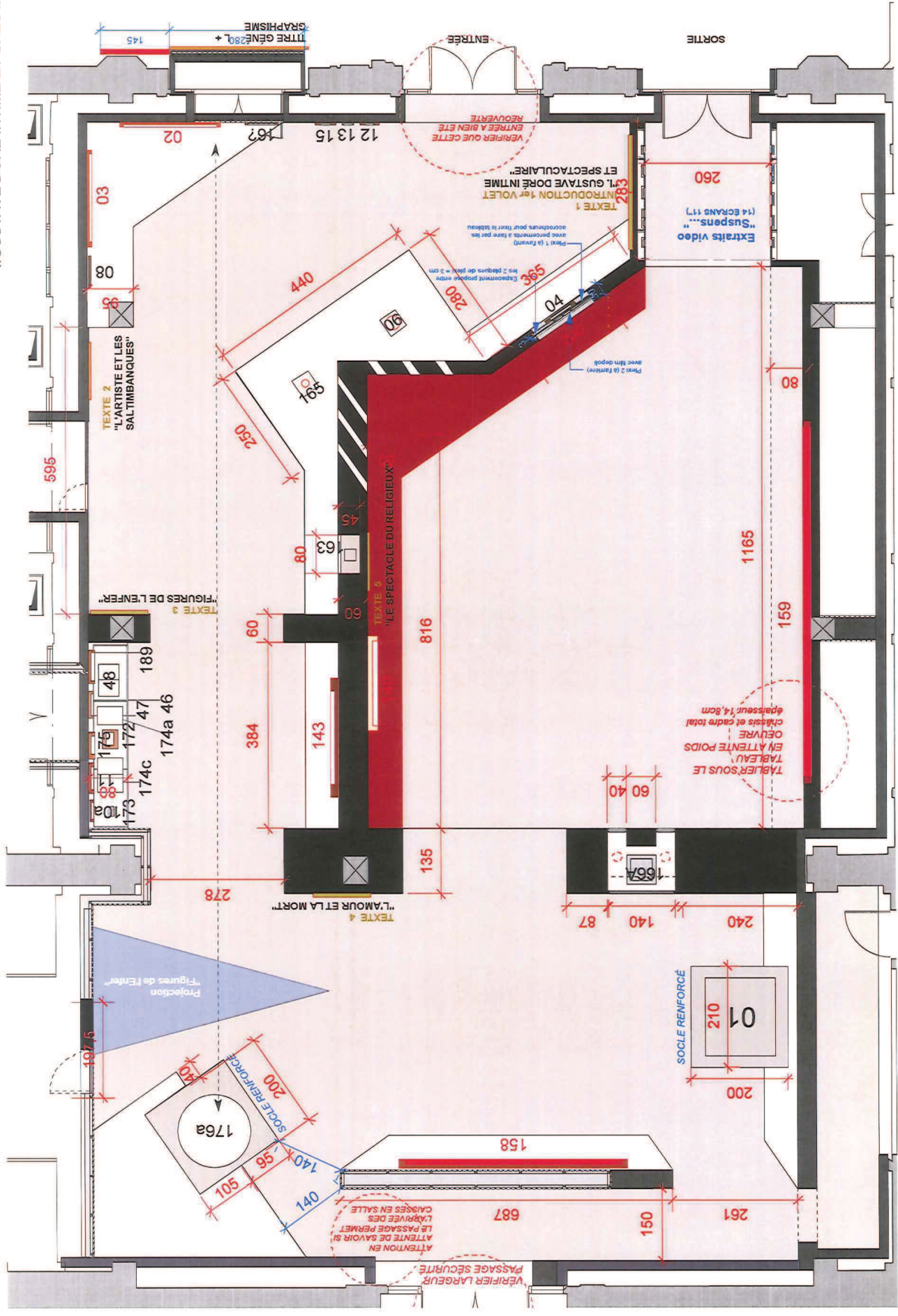

3 MI 3 S

Document n°5 4/10

# "I. GUSTAVE DORÉ INTIME ET SPECTACULAIRE"



COUPE GG



COUPE HH

agence	50 rue du Fbg du Temple, 75011 Paris, France Tel. _01 46 28 35 96 Fax _01 46 28 35 70	MUSEE D'ORSAY	DCE	COUPES GG ET HH "I. GUSTAVE DORÉ INTIME ET SPECTACULAIRE"	1/75	16/01/2014	DATE
							ÉCHELLE
							LOGO

MUSEE D'ORSAY  
 Agence NC  
 Etablissement public du musée  
 d'Orsay et du musée de l'Orangerie  
 (EPMO)

"Gustave Doré (1832-1883).  
 L'imaginaire au pouvoir"

PROJET

LIBR

PHASE

TITRE

ÉCHELLE

DATE

"II. DE LA CARICATURE AU PAYSAGE"

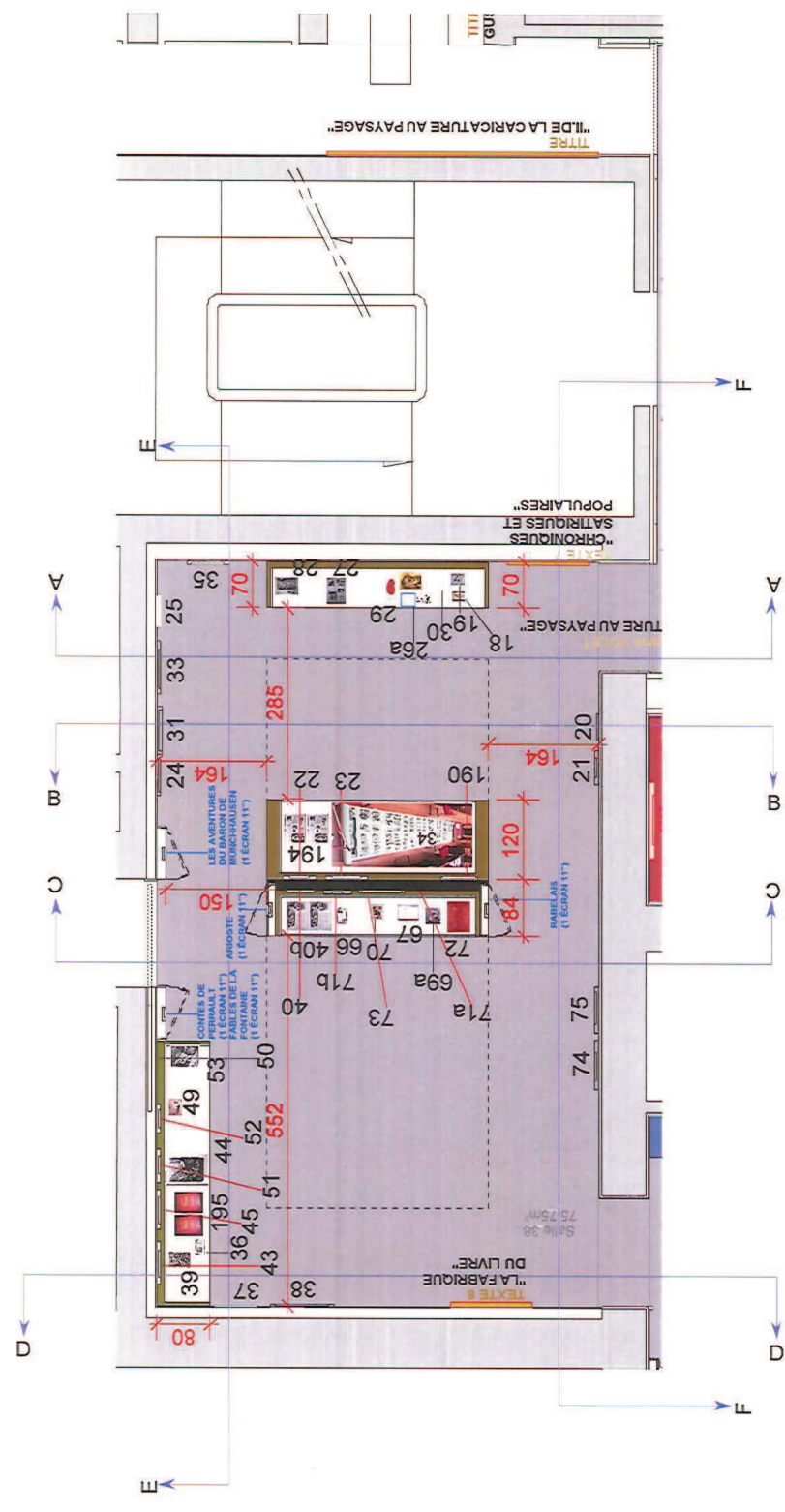



34 194

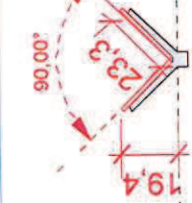

39

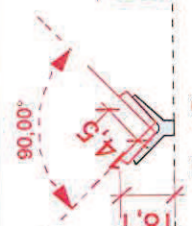

36

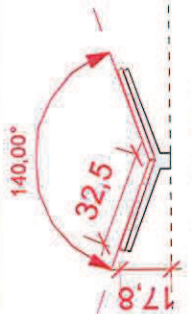

195

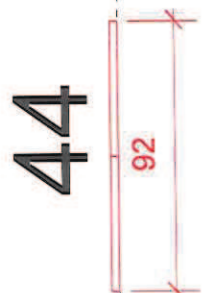

44



49



53

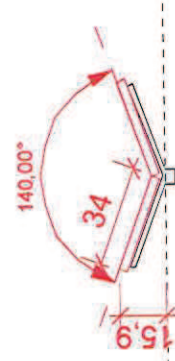

40b

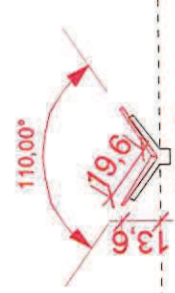

66



70

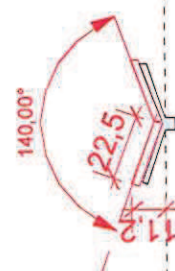

67



69a

Attention à isoler des autres dans la vitrine



40c



66

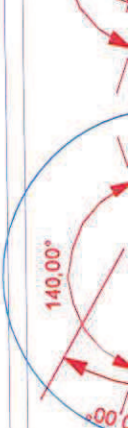

70



67

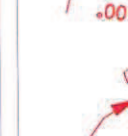

69a

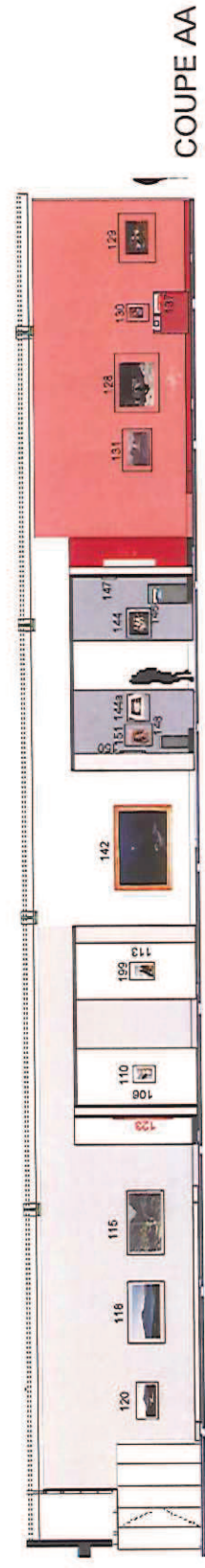
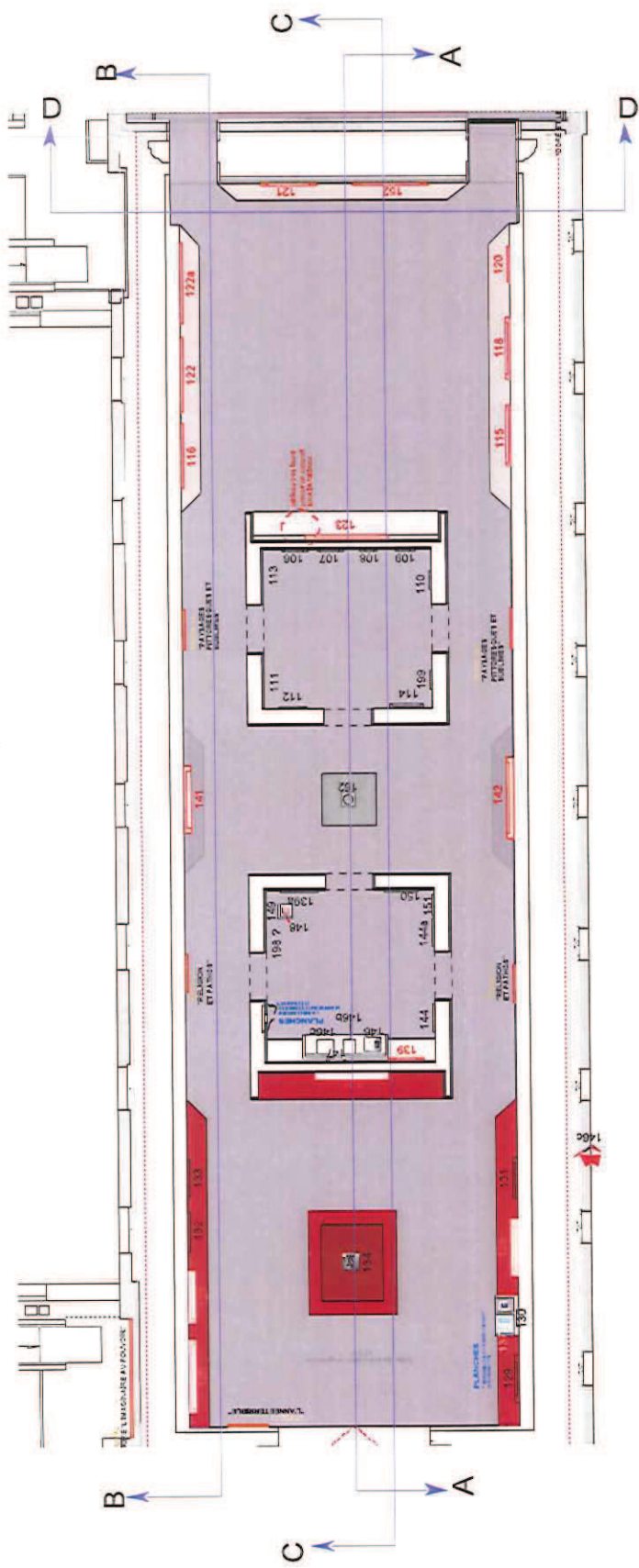

COUPE AA

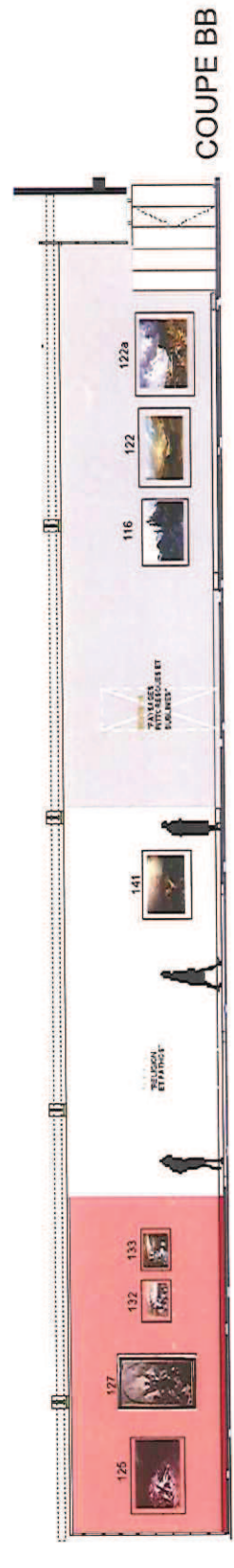

COUPE BB

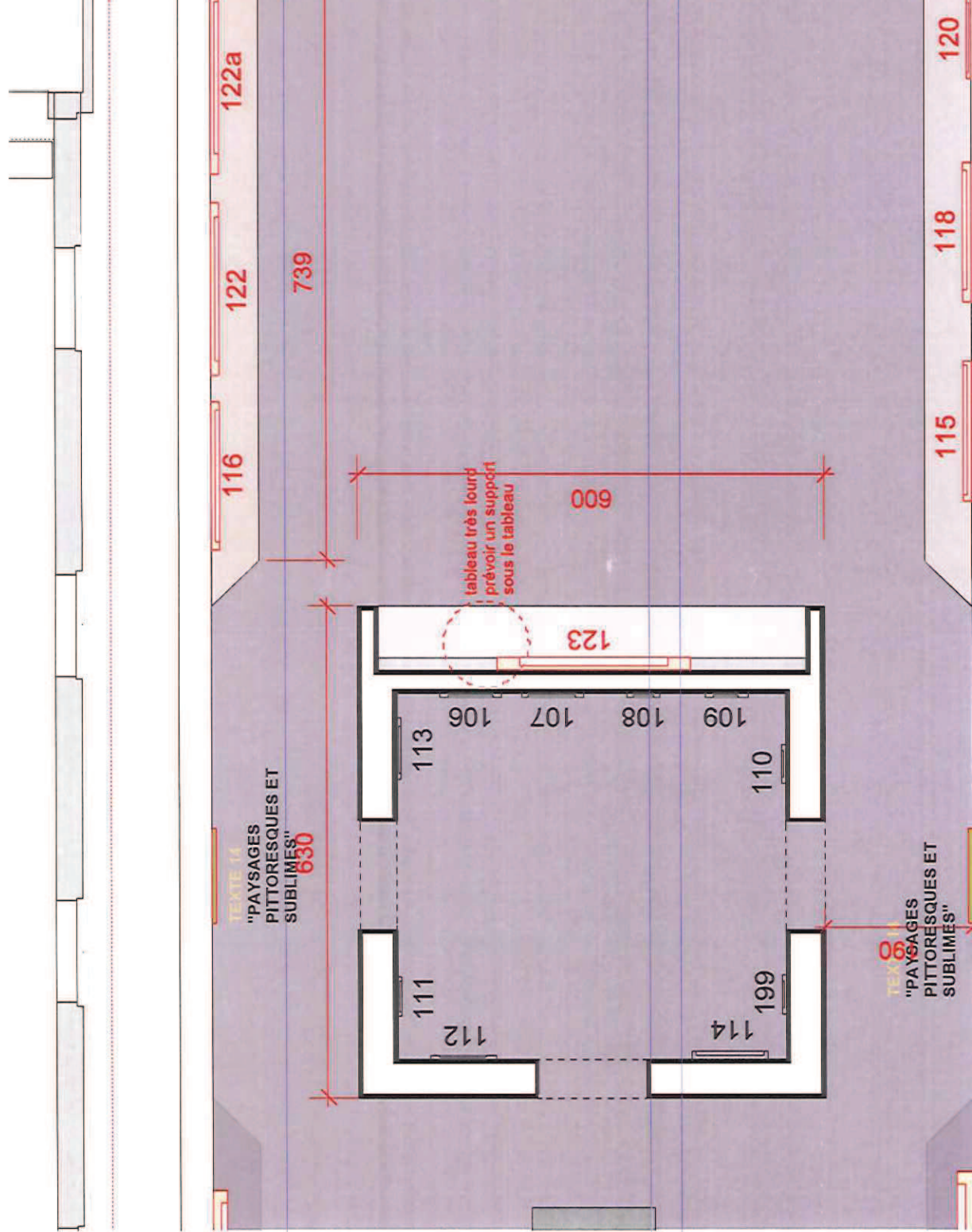

B

C

A

TEXTE 14  
"PAYSAGES  
PITTORESQUES ET  
SUBLIMES"  
630

TEXTE 14  
"PAYSAGES  
PITTORESQUES ET  
SUBLIMES"  
630

tableau très lourd  
prévoir un support  
sous le tableau

600

739

116

122

122a

115

118

120



